

NAPA VALLEY FORWARD

SR-29 Intersection Improvements at Rutherford Road and Oakville Cross Road

Project Overview



Proposed Improvements

SR-29 and Oakville Cross Road

Adding a roundabout

SR-29 and Rutherford Road

Signalization and safety enhancements



Napa Valley Transportation Authority is working with the **Metropolitan Transportation Commission** on multi-modal safety and operational improvements on SR-29 in Oakville and Rutherford.

SR-29 is the only contiguous north-south route that connects Napa to the adjacent counties of Lake and Solano. It is a critical evacuation route during wildfires and other emergencies.

Objective

Improve safety and reduce congestion for all modes and operations.

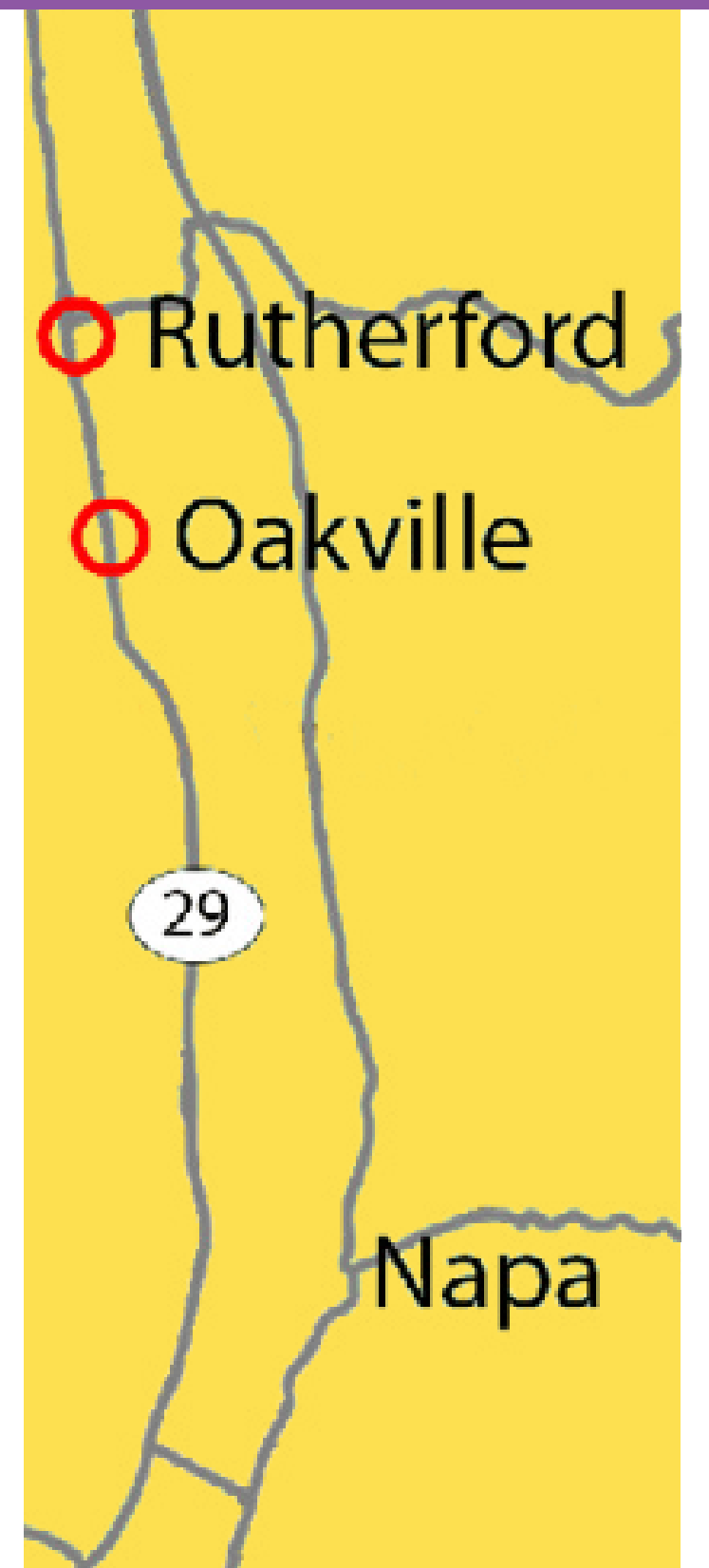

Rutherford

Oakville

29

Napa

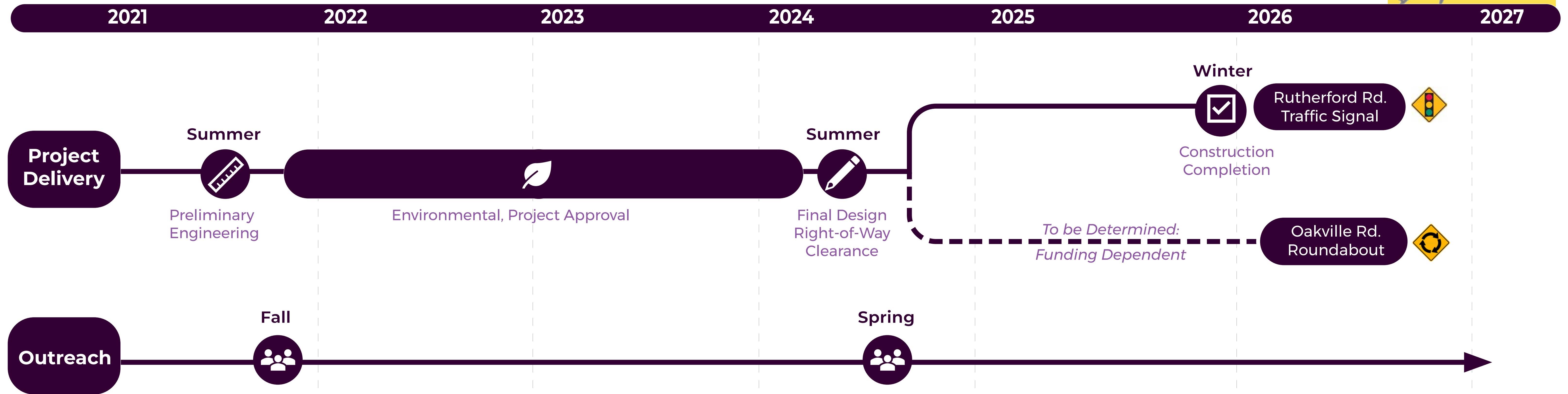

NVT
NAPA VALLEY TRANSPORTATION AUTHORITY

Rutherford

Existing Conditions



No traffic controls (stop signs) on SR-29

Unprotected left-turn movements

No marked crosswalks for pedestrian and bicyclist crossing

Bus stop located on northbound and southbound SR-29 shoulder

Railroad crossing control is by stop sign

Railroad crossing is at the intersection

Narrow State Highway right-of-way

State Highway is constrained by railroad and existing developments

Traffic Signal is the preferred alternative for this intersection



Q Traffic signal improves safety by protected vehicular and pedestrian movement

Traffic signal construction fits within existing public right-of-way

Roundabout requires greater right-of-way than traffic signal

Traffic Signal Control Rendering

Rutherford

Proposed Project: Traffic Signal

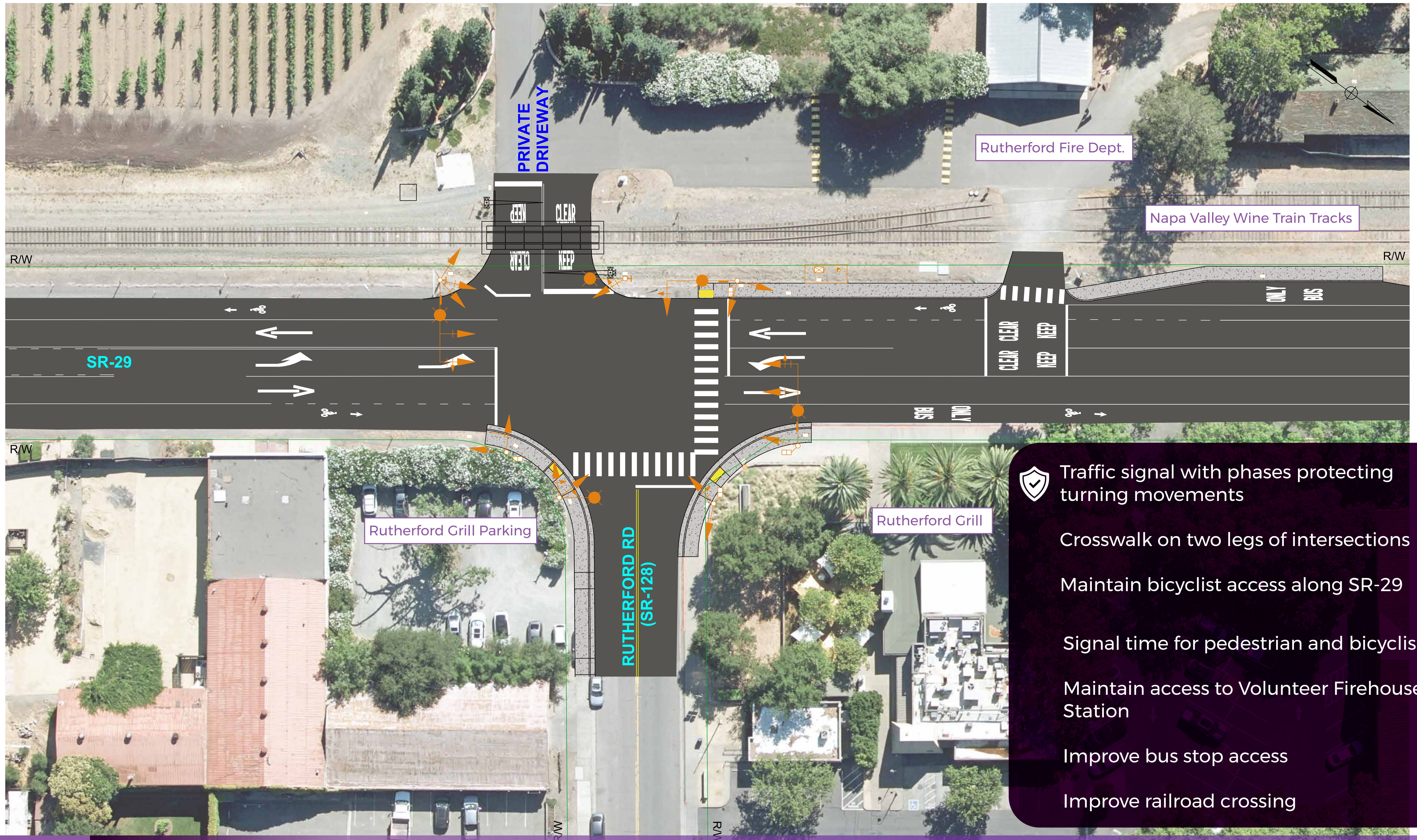

- ✓ Traffic signal with phases protecting turning movements
- Crosswalk on two legs of intersections
- Maintain bicyclist access along SR-29
- Signal time for pedestrian and bicyclists
- Maintain access to Volunteer Firehouse Station
- Improve bus stop access
- Improve railroad crossing

Rutherford

Proposed Project: Traffic Signal

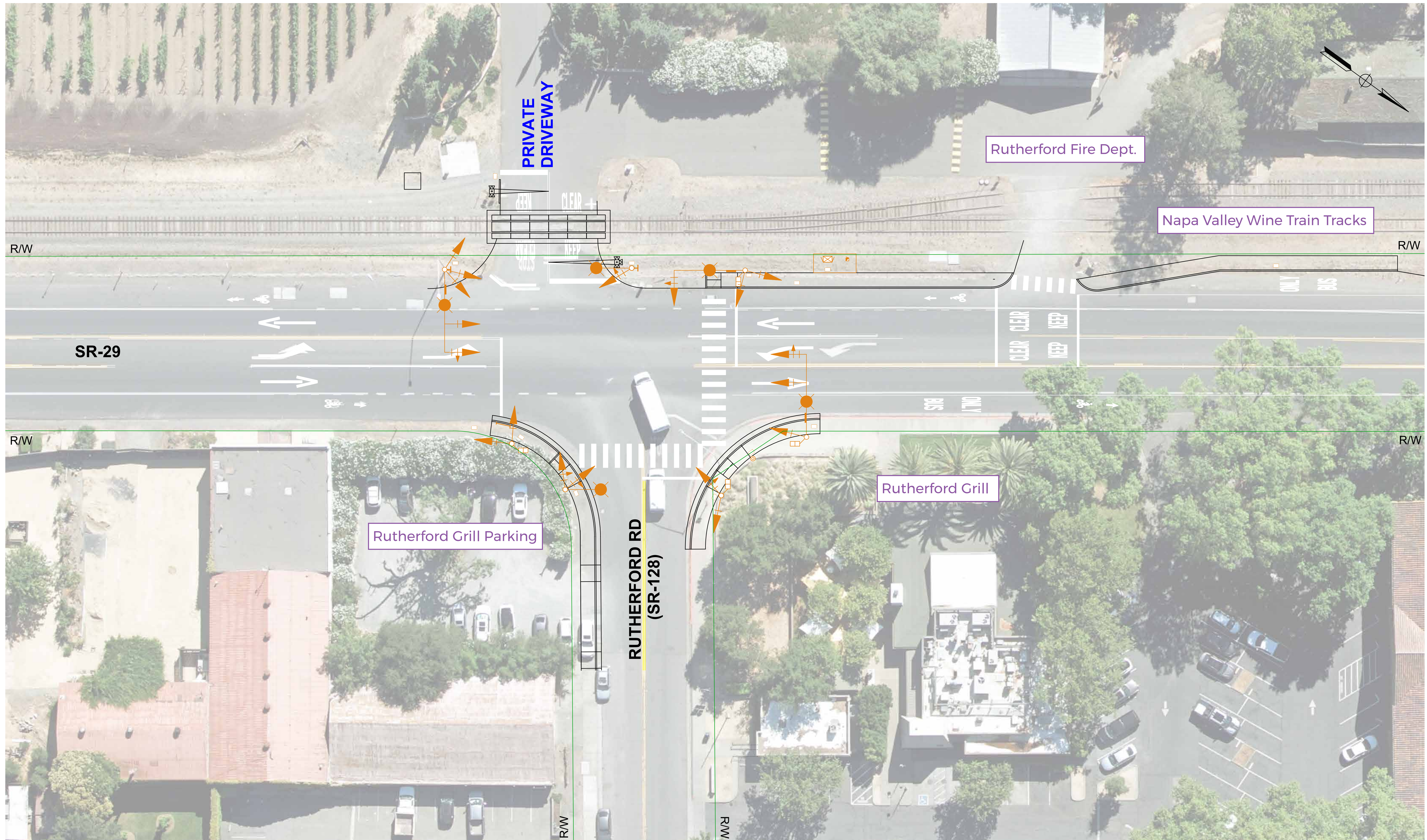

Oakville

Existing Conditions



- No traffic controls (stop signs) on SR-29
- Unprotected left-turn movements
- No marked crosswalks for pedestrian and bicyclist crossing
- Railroad crossing is at the intersection
- Railroad crossing control is by stop sign
- Narrow State Highway right-of-way
- State Highway is constrained by railroad, vineyard and other existing improvements
- Historical building: Grocery store

 Roundabout is the preferred alternative for this intersection



Roundabout provides traffic operations that improves safety while also reducing congestion

Roundabout improves access for bicyclists and pedestrians

Adjacent property owners are supportive of roundabout at Oakville

Roundabout Rendering

Oakville

Proposed Project: Roundabout

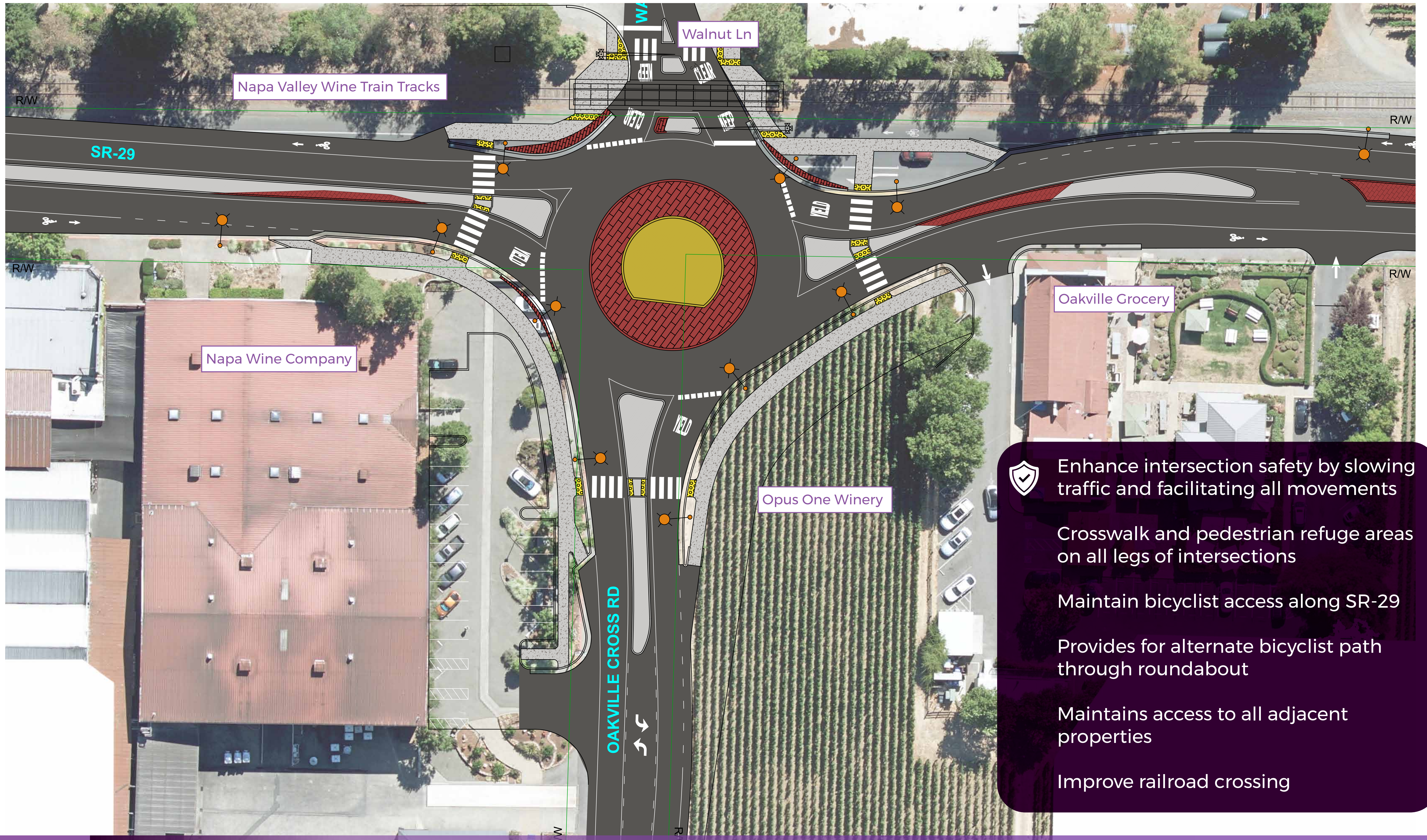

- Enhance intersection safety by slowing traffic and facilitating all movements
- Crosswalk and pedestrian refuge areas on all legs of intersections
- Maintain bicyclist access along SR-29
- Provides for alternate bicyclist path through roundabout
- Maintains access to all adjacent properties
- Improve railroad crossing

Oakville

Proposed Project: Roundabout

